

enfieldracing.com

A division of:
Mold Threads, Inc.
21 West End Ave
Branford, Ct 06405

enfieldracing.com

A division of **Mold Threads, Inc.**

***Manufacturer of Racing Parts for
Vintage Harley & Indian Motorcycles***



All Parts Race Proven

***Home of the 'Rubber Ducky Float'
And
Peek Intake Manifold 'Super Seals'***

Bruce G Argetsinger
Mold Threads, Inc.
21 West End Ave
Branford, CT 06405
Ph: 203-483-1420, Fax: 203-483-1568

Date: 01/28/16

Available Summer 2016

Ordering information

If you wish to order from this catalog by credit card, please contact us by phone at **203-483-1420**. We *do not* take credit cards over the phone but we can send you a PayPal invoice to your email address which you can pay with any credit card. *You do not need a PayPal account to pay the bill. If you have a PayPal account, you can send money with a note of what you wish to purchase to : moldthread@aol.com.*

You may also contact us by email at : **moldthread@aol.com**

If you wish to order by mail, please make out check or money order to : **Mold Threads, Inc.**

Item #	Description	Quant.	Price	Total

Shipping:

Total.:

Send check or money order made out to:

Mold Threads, Inc.
21 West End Ave.
Branford, CT 06405

Ship to:

Name.....
 Address:.....
 Apt# or Suite #:.....
 City:..... State:..... Zip:.....

Approximate shipping charges which include insurance:

Up to \$50.00.....\$8.00
 \$50.00 to \$100.00.....\$11.00
 \$100.00 to &300.00.....\$16.00
 \$300.00 to \$500.00.....\$20.00

Above \$500 please call for shipping charges

For International shipping charges: Please call for more information

Your New source for Harley Flathead cylinders

**UL Cylinders, cases
& cam covers**

KR & K Cylinders

We now offer you vintage Harley engine components formally made by S&S Cycle. Avoid, If you can, using original cylinders and engine parts for two reasons. The old parts you find today are far from stock bore and have limited life. How do you deal with broken tins? Additionally modern Iron cylinders are cast from vastly superior metals alloys. They are stronger and last longer. Today's foundry techniques far surpass engine components made in 30s, 40s & 50s. And don't try to save money with offshore engine parts because they are of uncertain material and machining quality which can bite you after the build when you are supposed to be riding. Exact pricing is to come. **Call to pre-order for 2015 delivery on: UL cylinders, UL cases, UL cam covers or K/KR cylinders**



ENFIELD RACING.COM

A division of Mold Threads, Inc.
 21 West End Ave • Branford, CT 06405
 Phone 203-483-1420 • Fax 203-483-1568
 Email, info@enfieldracing.com
www.enfieldracing.com

Easy pay with...
PayPal



Americans made for your
 American motorcycle

ENFIELDRACING.COM

This Enfield Racing division has been an outgrowth of my own Vintage Flat Track Racing experience. The classes I race are using the oldest motorcycles in AHRMA Racing and over the years I have come to the conclusion that the value of these machines and scarcity of parts has kept many potential riders from using them for their intended purpose.

Enfield Racing is an attempt to solve this problem by combining modern materials and modern manufacturing technology to produce parts that have a strength and quality that was unheard of when these machines were manufactured. In addition there are an incalculable numbers of years of experience available from those riders, which made these machines famous in their period.

You may be assured that all of our products are made to the highest quality standards and utilize the knowledge gained from over 40 years in the Tool and Die business and decades in motorcycle competition.

ALL PARTS OFFERED ARE INTENDED FOR RACING PURPOSES AND NO WARRANTY CAN BE GIVEN OTHER THAN FOR QUALITY OF MATERIALS AND WORKMANSHIP. IT IS YOUR RESPONSIBILITY TO DETERMINE IF THE PART IS SUITABLE FOR YOUR APPLICATION.

****Prices and Specifications subject to change
without notice***

RUBBER DUCKY FLOATS

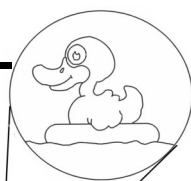
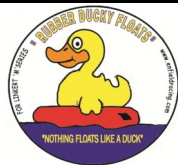

THE ORIGINAL

LOOK FOR THE RUBBER
DUCKY LOGO ON EVERY
FLOAT

**BEWARE OF
IMITATIONS!**

Same size and weight
as original

Price: \$40.00
Order #: RDF-LF
OEM #27379-33

QUANTITY DISCOUNTS AVAILABLE.

These Linkert Floats fit all Linkert M Series Carburetors. These are **NOT** the old Armstrong Floats that were made by H-D years ago. These **RUBBER DUCKY FLOATS** have been tested in the modern fuels available today that contain ethanol and oxygenates. Our tests have also shown them to be reliable in 112 Octane Leaded Race Gas. This is Absolutely the best and last float you will ever buy for your Linkert Carburetor.

We are the only manufacturer that dares put their name on their float!

Guaranteed not to leak or swell !

FLOAT SCREW SET



IF YOUR ARE REPLACING A BRASS
FLOAT, YOU WILL NEED A FLOAT
SCREW SET TO INSTALL THE FLOAT

Price: \$6.00
Pt# RDF-LS-SS
OEM#27278-33

Quantity discounts available

HONDA XL 350 ROCKERS

Exhaust and Intake

Made in USA of 4340 steel.

Uses std. adjuster or KTM

'Elephant Foot'

***Improved Design ***

INTAKE

Price: 150.00

Pt #: HO-RI

EXHAUST

PRICE: 150.00

Pt#: HO-RE

SET: HO-SET \$ 300.00



We Thank you for your interest in our products. We try to make the finest parts on the market today! Bruce

TRIUMPH RACING PRIMARY COVERS

650-750 twins

2 or 3 row primary or belt drive.

Flat Track Style

Price: \$325.00

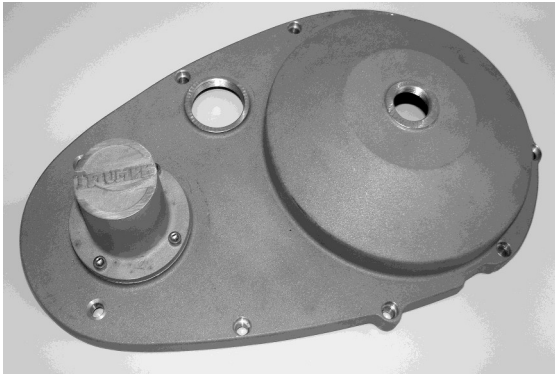

Starter Kit

Price: \$125.00



Alternator Style

Perfect for street tracker

Price: \$375.00

**WE ARE WORKING ON THE A65 BSA TWIN
PRIMARY COVER**



Fox Photography 1foxracing@gmail.com

Ronnie Rall (age 70) on one of my
Enfields at Canton, Ohio 2011

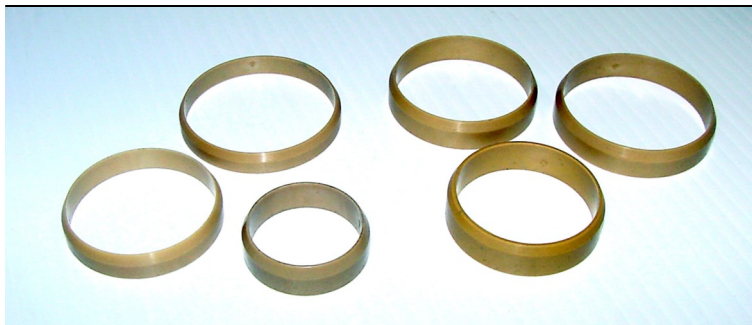

Peel Intake Manifold “Super Seals”

These are the seals you have heard about that can eliminate intake leaks', now at an affordable price, because of our investment in precision injection molds, and our expertise in molding exotic engineering materials.

PEEK has a melting point of 650° F (343° C) with a continuous use temperature Of 500° F. It has outstanding creep resistance for an engineering tthermo-plastic material and can sustain large stresses over a useful service life Without significant time induced extrusion.

ENFIELD RACING is the only manufacturer in the world of injection molded seal rings for vintage V-Twin motorcycles in stock sizes.

Price: \$40.00 per set of 2 (Quantity discounts available)

Part#	fits	
HD-1 1-9/16" ID	1930-48 74" & 80" Flathead 1936-39 61" OHV 1940-46 WLDR ?	H-D # 27057-30
Hd-2 1-7/16" ID	1932-73 45" W & G models	Orig H-D # 1118-30 New :H-D # 27058-30
HD-3 1-45/64" ID	1940-54 61" & 74" OHV (Knuckelhead & Panhead)	Orig H-D # 1118-40 New H-D # 27059-40
IND-4 1-1/2" ID	1932-54 74" & 80" Chief	Indian # 38135
IND 5 1-11/16"	1934-42 45" Sport Scout	Indian # 40165
Ind 6 1-3/32" ID	741 Jr Scout	Indian # 26822

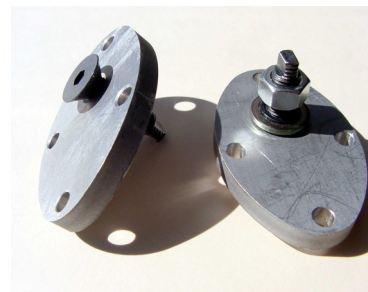

OIL PUMP END CAPS

These modern made caps will eliminate oil pump worm and spindle failure problems.. Fis all single cylinders. These caps will buy you peace of mind on the track or highway

Part #: RE-OP
Price: \$75.00/ set of 2

TIMING GASTET COVER FOR 1945-1956 BULLETS

The important thing is –we have em. You won't have to shop the world's obscure little places because they're on our shelf right now...now! Timing side oil seal replaces old leaky felt seal with modern lip seal.

Part #: RE -TCG
Price: \$5.00
OEM#: 38060

DRIVE SIDE OIL SEAL

Modern rubber lip seal to replace antique felt

Part #: RE-DSS
Price: \$7.50

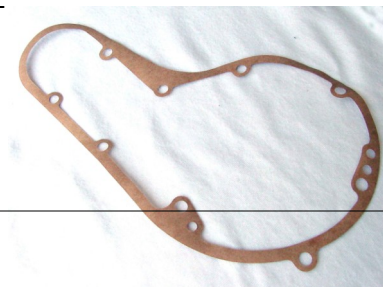

ALLOY PUSHRODS FOR ALL 350 & 500 SINGLES

Made of highest strength aluminum available anywhere. Aluminum is also of higher weight for performance. Push rods were machined with fine threads so you can achieve precision timing adjustment.

Fits all 500cc Bullets big head Fury models and 350 Enfield.

350 Bullet
Part #: RE-350B
Price: \$85.00/set

500 BULLET
Part #: RE-500B
Price:\$85.00

500 Fury
Part #: RE-500F
Price:\$85.00



ROCKERS FOR BIG HEAD FURY

Lighter weight . Fitted with care-free needle bearings. Thrust washer included..



Part #: RE-RF
Price: \$300.00/set

STEERING HEAD SEALED TAPER ROLLER BEARINGS

(For English or India made)

For proper handling from your frame, toss your old stock ball bearings. Use these updated Timken tapered roller bearings with integral seal. These are the exact replacement for all Redditch models with cast headstock.

Redditch
Part #: RE-SR-1
Price : \$185.00

INDIA
Part 3: RE-SB-1
Price: \$250.00

Also Model for India made tube frame

**MAGNETO MOUNTS**

For Fairbanks- Morse, Joe Hunt, and Morris Magnetos. Adjustable mounting plates to fit all Bullet Models 1948-2006



Part #: RE-MM
Price: \$145.00

MAGNETO CAPS for FAIRBANKS-MORSE and similar magnetos (JOE HUNT, MORRIS)**ALSO AVAILABLE IN CLEAR**

FOR TWINS AND DUAL PLUG SINGLES - Made of glass filled polyester resin, has better electrical properties, and will not crack like old style BAKLITE, fuel and chemical resistant. This is the same material we use to mold the distributor caps that are used by NASCAR. All inserts are brass. Available in 2 styles. Standard \$38.00 - same as original,

Racing - uses regular spark plug caps on both ends of wire WIRES WILL NOT COME OUT!



Price: Ffm Standard: \$38.00
Part#: FM-Mag
Red, Black & Clear

Price: FM racing: \$ 50.00
Part # FM- Mag- R
Red & Black

EDISON SPLITDORF "RM" MAGNETO CAPS

Now available in both 2 & 4 cylinder engines. These are of the highest quality injection molded caps with all brass and stainless Steel components **guaranteed unbreakable**



Price: ES-RM 2 cylinder: \$250.00
Part #: ES -Mag -2

Price: ES -RM 4 cylinder: \$300.00
Pt # : ES- Mag -4

Magneto Parts



EDISON /SPLITDORF RM MAGNETO COIL COVER

**VIRTUALLY UNBREAKABLE
POLYCARBONATE/ POLYESTER MATERIAL
WITH MOLDED-IN BRASS INSERTS.**

Part #: FS-CC
Price: \$75.00
OEM: #: 6438

EDISON/SPLITDORF RM ROTORS



These fit both the 2 & 4 cylinder caps that we make
Please note that Edison/Splitdorf made many rotors that look similar but do not work.

Part #: ES-ROT
Price: 50.00

What's wrong with your old Magneto Cap?

Up until the 1960's all magneto caps and distributor caps were made of a type of Pheonolic resin named Bakelite after it's inventor in 1915. This resin made all sorts of things possible including our ignition parts. At the time it was a very important material.

It had 2 major problems however. It was brittle and worse, it absorbed moisture. This lead to internal tracking of the spark over time and misfiring of plugs.

During the 1960's and 70's tremendous advances were made in polymer science. The materials we use in our ignition parts are from that era. We use some of the same materials to mold magneto caps that we use to the mold distributor caps for the NASCAR cars. They have about 0% water absorption and several times the mechanical properties of the original Bakelite.

Even though you have a motorcycle 75 to 100 years old, there is no reason not to be in the 21st century with 21 century materials.

INDIAN PARTS



INDIAN RACE VALVES

High quality stainless steel valves made for us by **Manley**.
Intake 1.750, exhaust 1.625 with 35° angle. Stems are .310 dia. Guides must be honed.

FOR MY RACE CYLINDERS

Part #: IND-VS
Price: \$160.00 set of 4

INDIAN BUSHING, CAM FOLLOWER SHAFT

Fits in cover.

.Nobody else is making these!

OEM#: 20B92

Part #: IND-LSB
Price: \$15.00 each



INDIAN VALVE LIFT SHAFT

Thru hardened 50-55 RC, surface then nitrated to 65.74RC
Prevent Valve Train failure caused by bad lifter geometry, high spring pressure, and radical cam profiles.

Part #: IND-LS
Price: \$25.00each
OEM: IND # 20B91

INDIAN REAR SECTION

741 Rear section to fit Scout Frame.

Gives more ground clearance.

All chrome-moly tube and casting.

Part #: IND-RS
Price: \$1,500

Scout rear tabs
Part #: IND-RT
Price: \$300.00 pr



INDIAN SHIFT LEVER

Rear left mount nickel plated.

Part #: IND-SL
Price: \$225.00

INDIAN PARTS

INDIAN VALVE GUIDES

Precision machined cast iron valves guides to fit Scout cylinder and 5/16" valve stem.
Class 40 gray iron. For 5/16" stems

Part #: IND-VG
Price: \$160.00



INDIAN PUSH ROD GUIDES

Bronze guides to use with our WR valve covers

Part #: IND-PG
Price: \$200.00 per set of 4



INDIAN VALVE SPRINGS

Beehive valve springs made of OVAITE wire / Fits inside WR Valve covers. Handles more aggressive cams. Eliminate valve float.

Part #: IND-SP
Price: \$ 100.00 set of 4



INDIAN VALVE SPRING RETAINERS

Ultra high strength aluminum, 1/2 the weight of the original steel.
FOR USE WITH OUR BEEHIVE SPRINGS

Part #: IND-SR
Price: \$50.00 per set of 4



Magneto Parts

SPLITDORF NS MAGNETO CAPS FOR TWINS

OME OF THE LATEST REPLICAS OF THE ORIGINAL BUT WITH NEW MATERIALS AND MOLDING TECHNIQUES. SAME REDDISH BROWN COLOR. CAST BRASS INSERTS MOLDED-IN, THEN MACHINED FOR ROTOR

Part #: NS-2
Price: \$300.00
2 CYL

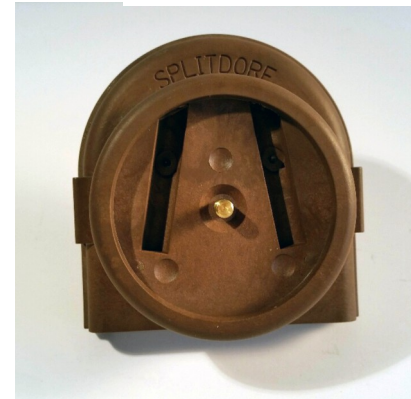

EDISON/SPLITDORF WIRE RETAINER

For 2 cylinder NS-2 magneto.
Molded in original Phenolic material with brass insert.

Part #: ES-NS2
Price: \$50.00



SPLITDORF NS ROTOR FOR TWINS AND FOURS.

AN ORIGINAL DUPLICATE IN MOLDED RYTON WHICH WILL NOT FAIL YOU. ALL BRASS INSERTS MOLDED IN. ACCEPTES ORIGINAL CARBON BRUSHED AND SPRINGS

Part#: #: NS-ROT
Price: \$100.00



Magneto Parts



Splitforff Rotor Brushes

For ALL NS Magnetos
Same as original

Part # : NS-B
Price: \$10.00 set of 2l

SPLITDORFF NS MAGNETO CAPS FOR FOUR CYLINDERS

A DUPLICATE OF THE ORIGINAL BUT WITH NEW MATERIALS AND MOLDING TECHNIQUES. SAME RED-BROWNISH COLOR/ CAST BRASS INSERTS MOLDED IN, THEN MACHINED FOR ROTOR.

Part # :NS-2 Magneto Cap
Price: \$350.00
4 CYL



SPLITDORFF NS WIRE NUTS FOR FOUR CYLINDERS

MODERN MATERIAL WITH KNURLED BRASS INSERTS

Part #: NS-NUT
Price: \$10.00 each



INDIAN PARTS

648 Cam Cover

For aluminum or cast iron pumps.
Machined to factory drawings.
Part#: IND-CC
Price: \$400.00

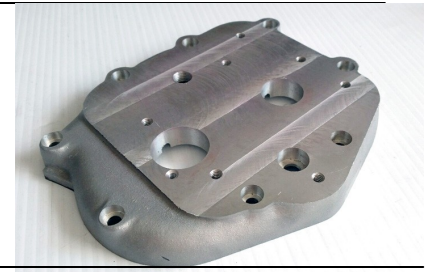

Also fits earlier Scouts

Standard 3bolt
Price: \$200.00
Part#: IND-IM-3

SCOUT INTAKE MANIFOLD

Precision cast in silicon bronze
Available in 3 configurations.

4 Bolt (HD carb)
Price:\$200.00
Part#: IND-IM-4
(Requires some relief of fins)

Mikuni 36-38 mm
Price: \$175.00
Part#: IND-IM-38

**Limited time only !*

**FREE set Super Seals
with Manifold**



BIG BASE ENGINE PLATES

Rear engine plates to fit the big base cases .

Price:
Rear: \$80.00/set
Part: IND-EP-R

Front: \$60.00/set
Part: IND-EP-F

Same as Standard Scout & 741



TALL FIN HEAD SCOUT HEADS

Only some of the 648 motors had these heads.

Machined combustion chamber for 7: 1 compression.
14 mm plugs

Part#: IND-TFH
Price: \$1000.00 a pair



INDIAN PARTS

BIG BASE SCOUT CYLINDERS

These are improved copies of the famous 45 cu-in Big Base Indian Scout cylinders. They feature larger and thicker base flanges and improved intake and exhaust ports. Sand cast in class 30 grey iron, normalized then precision machined on our own CNC machining centers.



Price: \$1800.00/set
Part#: IND-CYL

HIGHLY MODIFIED RACE VERSION: \$2,500.00

RACE QUALITY FORGED BONNEVILLE SCOUT PISTONS



Manufactured for us by **WISECO**, these are the highest quality forged pistons available. 1 mm top ring, 1.2 mm second ring and 3 piece oil ring,. Coated skirt, complete with pin and wire locks.

Standard, +.020, +.040 & also STROKER
.125 popup

Price: \$150.00 each
Part#: IND-SP

BIG BASE ENGINE CASES Model 648



Cast in 356 aluminum, heat treated, machined to factory drawings for the "1947-45 Special"

Price: \$2,250.00/set
Part#: IND-EC

*Our Aluminum is 40% stronger than the Factory

H-D Parts

PEEK-A-BOO WR STYLE CAM/TIMING COVER 1950 & 1951

Precision cast in 356 alloy aluminum. Heat treated to T-6. Fully machined with all bushing installed and pinned, oil holes drilled. Machined for various configurations.

WR with ball bearing and forward magneto.

WL & G with bushings and generator

Part #: WR-CC
Price: \$1,295.00
OEM#: \$25202-50R

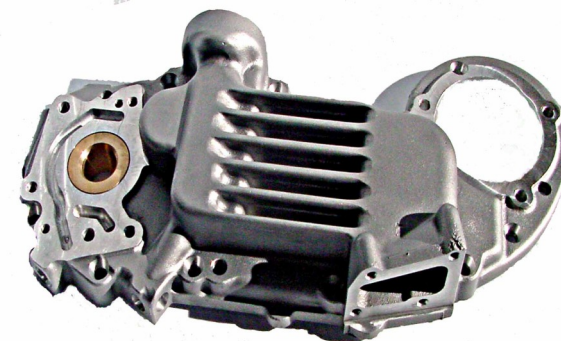

KR, XR750 AND Sportster Racing Primary Covers

Computer designed to match case holes with 1/64t" clearance for perfect fit.

Cast in 356 aluminum alloy and heat treated to T-6 Gasket surface machined, not sanded.

Includes all screws, gaskets and O' rings

Narrow for KR & XR750:

Part # PC-XR
Price: \$340.00

Wide for XLCH Sportster thru 1967

Part #: PC-CH
Price: \$ 320.00

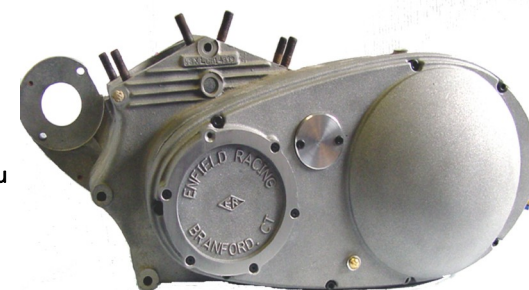

Starter Kit

Price: \$145.00

STARTER NUTS AVAILABLE

Standard K 5/8-16
S & S 3/4-20
Sportster 3/4-16



H-D Parts



FOOT PEG MOUNT

Moves left foot peg to rear of Primary cover for flat track racing . Includes screws and spacers.

Part #: KR-PM
Price: \$65.00

WR TAPPET GUIDES *THE WEIRD ANGLED ONES*

Updated version of the angled WR tappet guides cast in silicon bronze . These take the WL /KR roller tappets. Not for use with flat tappets.

Allows the use of hotter KR profile cams in early engines.

Part #: WR-TG
Price: \$600.00 set of 4



HD VALVE GUIDES

Precision machined valve guides to fit WR & K models. Class 40 gray iron.

Part #: HD-VG
Price: \$160.00 per set of 4



H-D Parts



KH TAPPET ADJUSTER SCREW SET
Longer adjusting screws for the higher KH cylinders.

Part #: KH-TA
Price:\$40.00 set of 4

WL/WR MAGNETO IDLER SHAFT

Allows WL cases to use forward horizontal Magneto. NO MACHINING NECESSARY! Must use WR cam cover and idler gear.-

Part #: WL-IS
Price:\$90.00

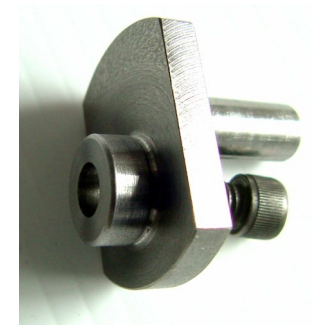

KR MAGNETO ADAPTER PLATE

Adapter plate to fit Fairbanks Morse magneto . To KR and XR750.

Part #: KR-AP
Price:\$95.00
OEM#: 29600-56R



Special 5/16" Flathead screws

HD# 1957R

Part#: KR-AP-S
Price: \$10.00 each (2 required)



H-D Parts

**BREATHER VALVE (FLUTTER)**

It's the little valve in the cam cover.
Fits all UL, WL, WLDR, WR and GT models.

Price: \$25.00
Part#: WL-BV
OEM#: 25350-37

WR-KR SPROCKET NUT

Fits WR, KR and XR750 brakeless rear hubs
Also fits many earlier models., J D etc.

Price: \$70.00
Part#: KR-SN

Sprocket nut wrench
Price: \$75.00
Part#: KR-NW

**WR/KR INTAKE MANIFOLD**

Precision cast in silicon bronze in

Standard 4 Bolt
Price: \$200.00
Part#: KR-IM

Mikuni 36-38mm
Price: \$175.00
Part#: KR-IM-38

Mikuni 40-42mm
Price: \$175.00
Part#: KR-IM-40



- Limited time only

Purchase a manifold and get FREE "Super seal set"

*****We are now set up to machine WL Cylinders to take WR Intake nipples.*****

\$100/ cylinder

H-D Parts

WR SPRING SETS

Higher spring rate to accommodate hot cams without coil bind.
Fits WL, WR, K and early KRS
Same lift and pressure as dual KR Spring.

Part #: WR-SP
Price: \$100.00
OEM # 81268-48

**KR VALVES**

High quality stainless steel valves made for us by **Manley**.
Standard size heads- intake 1.875, exhaust 1.625 with 45° angle, can be reground to 30°. Stems are .310 dia. Guides must be honed

Part #: KR-VS
Price: \$160.00 set of 4

Uses standard keepers.

**WR VALVE COVERS**

Telescoping aluminum valve covers to fit WR
Includes outer seal and retaining screw.

Longer available for KH cyl.

Part #: WR-VC
Price: \$80.00 set of 4

**WR VALVE SPRING RETAINERS**

Ultra high strength aluminum, 1/2 the weight of the original steel.

Uses standard keepers.
Fits WL, WR, K and early KR

Part #: WR-SP
Price: \$50.00 set of 4
Oem#: 18220-30



CAMS FOR SIDE VALVE HARLEY DAVIDSON

Part # KR-CP
Price: \$500.00



THESE ARE ACTUAL "KR" RACING PROFILES MADE IN PRE-HARDENED tool steel HOT CAM LOBES TO FIT MOST SIDE VALVE HARLEYS

THESE ARE ACTUAL "KR" RACING PROFILES MADE IN PRE HARDENED TOOL STEEL DESIGNED TO BE WELDED ONTO YOUR GEAR CLUSTERS.
ALSO TO FIT RL AND VL MODELS WITH .610 SHAFTS

THE LOBES ARE AVAILABLE: STRAIGHT - FOR STANDARD 45 & 80 cui ENGINES, OR WITH THE CORRECT TAPER ANGLES FOR EITHER "WR" OR "K" MODELS.
PROFILES AVAILABLE ARE: 1959 "A", 1962 "E", 1964 "F" (A DIRT TRACK FAVORITE), 1966 "H, J, C AND K

"KHK" PROFILES FOR ALL FLATHEADS

HARLEY RACING PISTONS for 45'S

Racing Quality Forged Popup Piston manufactured by **WISeco** exclusively for Enfield Racing with correct wrist pin. Available in standard and .020, .040 and .060 oversize. Coated skirt, gas ported. WL, WR, & K models with popup

1mm top ring
1.2mm 2nd ring
3pc oil ring

Part #: KR-PS
Price: \$150.00



WR CYLINDER HEADS

New cylinder heads cast in 356 alloy aluminum, heat treated to T-6 Custom machined combustion chambers to fit WL, WLDR, and WR. Can be manufactured for various compression ratios, pop up and dome pistons. Uses 14mm x 3/4 spark plugs.

Part #: WR-CH
Price: \$1,000.00/set



WR machined to the factory 49 R drawing
Volume 65cc

WLDR has a modified 49R combustion chamber
Volume 69cc



Can be custom machined for your piston & valves, at extra cost.